

# GN 425.3

Handles

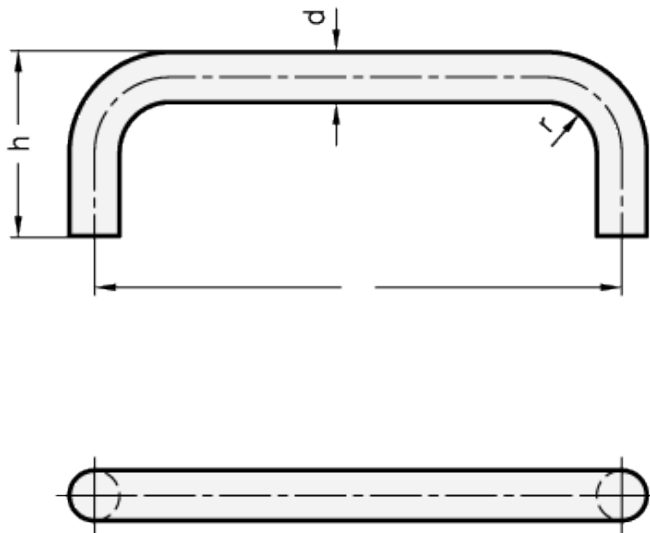

technical informations

**Material**

Steel ST, sandblasted matte finish.

**Assembly**

Welding.

*Special executions on request (For sufficient quantities)*

Different lengths.

*Features and applications*

The manufacturing process (bending) of the cabinet "U" handles GN 425.3 allows the production of special lengths in relatively small quantities.

Standard Elements	Main dimensions				Weight
Description	d	l <sub>±0.5</sub>	h	r	g
GN 425.3-10-125-ST	10	125	43	12	110
GN 425.3-10-160-ST	10	160	43	12	130
GN 425.3-12-125-ST	12	125	51	14	170
GN 425.3-12-160-ST	12	160	51	14	210
GN 425.3-12-200-ST	12	200	51	14	245
GN 425.3-16-125-ST	16	125	59	18	320
GN 425.3-16-160-ST	16	160	59	18	370
GN 425.3-16-200-ST	16	200	59	18	440
GN 425.3-20-200-ST	20	200	68	22	700
GN 425.3-20-250-ST	20	250	68	22	830



ELESA and GANTER models all rights reserved in accordance with the law. Always mention the source when reproducing our drawings.

**STANDARD MACHINE ELEMENTS WORLDWIDE**